

iQ500, Washing machine, front loader, 9 kg, 1400 rpm  
WM14UP89GB



Wifi-enabled iSensonic Washing Machine with intelligent i-Dos automatic dosing system and multiTouch LED Display.

- ✓ i-Dos – Automatically doses the precise amount of detergent and water.
- ✓ speedPack L – Speed up your programmes, or wash in just 15 minutes.
- ✓ Home Connect app (Android and iOS): access and control your washing machine, wherever you are.
- ✓ Remote control: manage your wash with your mobile device.
- ✓ Push notifications: know what your machine needs with the Home Connect app.

Energy Efficiency Class: .....A  
Weighted energy consumption in kWh per 100 washing cycles of eco 40-60 programme: .....46 kWh  
Maximum capacity in kg: .....9.0 kg  
The water consumption of the eco programme in liters per cycle: 48 l  
Duration of eco 40-60 programme in hours and mins at rated capacity: .....3:48 h  
Spin-drying efficiency class of eco 40-60 programme: ..... B  
Airborne acoustical noise emission class: .....A  
Airborne acoustical noise emissions : ..... 71 dB(A) re 1pW  
Built-in / Free-standing: ..... Freestanding  
Dimensions of the product: ..... 848 x 598 x 590 mm  
Weight: ..... 74.5 kg  
Connection Rating: ..... 2300 W  
Fuse protection: .....10 A  
Nominal power: .....220-240 V  
Frequency: .....50-60 Hz  
Length electrical supply cord: ..... 210.0 cm  
Door opening: .....Left  
Wheels: .....No  
EAN code: .....4242003908099  
Installation type: ..... Freestanding



- |          |  |
|----------|--|
| WX975600 | Floor securing component                 |
| WZ10131  | Extension for cold water inlet /Aquastop |
| WZWP20W  | Platform with pull-out, washer, cubic    |

## iQ500, Washing machine, front loader, 9 kg, 1400 rpm WM14UP89GB

### Performance

- Energy Efficiency Class<sup>1</sup>: A
- Energy<sup>2</sup> / Water<sup>3</sup>: 46 kWh / 48 litres
- Load capacity: 1 - 9 kg
- Programme duration<sup>4</sup>: 3:48 h:min
- Spin drying efficiency class: B
- Spin speed<sup>\*\*</sup>: 400 - 1400 rpm
- Noise level: 71 dB (A) re 1 pW
- Noise efficiency class: A

### Programmes/functions

- Touch control buttons: less ironing, soaking, Ready in, i-Dos 1, i-Dos 2, Child lock, Memory, remote start, Rinse plus +1+2+3, rinse hold, start/pause with reload function, temperature selection, varioSpeed, prewash, spin speed selection/Rinse Hold
- Standard programmes: cottons, easy care, delicates, wool hand wash
- Special programmes: automatic soft, drum clean with reminder, Outdoor, drain / spin, Remote Program, mixed fabrics, single rinse, rapid 15 minute quick wash, Hygiene
- Programmes via Home Connect app: Stain - Blood, Stain - Butter/Oil, Stain - Grass, Stain - Red wine

### Key features

- Home Connect: Remote Monitoring and Control
- varioSpeed: Up to 65% reduced washing cycle \*\*\*
- Reload Function: Stop the washing machine to add any forgotten items of laundry to the drum.
- i-Dos: automatic dosing of liquid detergent and softener
- antiVibration Design - for more stability and quietness
- iQdrive with 10 year warranty

### Additional features

- Large LED-Display for programme status indication, temperature selection, spin speed, remaining time and 24 hours end time delay, load recommendation and consumption indication
- Drum volume: 65 litres
- drum interior light
- waveDrum: for highly effective and extremely gentle laundry care
- drum clean with reminder function
- hydroSensor monitors and controls rinse cycles
- waterPerfect Plus: for efficient use of water even with small loads thanks to intelligent sensor technology.
- Consump indicator energy+water
- Detergent dispensing: i-DOS 2.0
- Aqua Protection
- Consumption indicator: Information about water and energy consumption prior to start of programme
- Jog dial with integrated on/off control
- Foam detection system
- Detergent over dosage display
- Out of balance load adjustment

- Electronic child safety package
- Acoustic signals: Buzzer

### Technical Information

- Slide-under installation
- Large silver-black grey door with 171° opening
- Dimensions (H x W): 84.8 cm x 59.8 cm
- Appliance depth: 59.0 cm
- Appliance depth incl. door: 63.3 cm
- Appliance depth with open door: 106.3 cm

<sup>1</sup> Scale of Energy Efficiency Classes from A to G

<sup>2</sup> Energy consumption in kWh per 100 cycles (in programme Eco 40-60)

<sup>3</sup> Weighted water consumption in litres per cycle (in programme Eco 40-60)

<sup>4</sup> Duration of Eco 40-60 programme

\*\* Values are rounded.

\*\*\* Comparison between the program duration of Easy-care 40°C and the program duration of Easy-care 40°C + activated varioSpeed option

**iQ500, Washing machine, front  
loader, 9 kg, 1400 rpm  
WM14UP89GB**

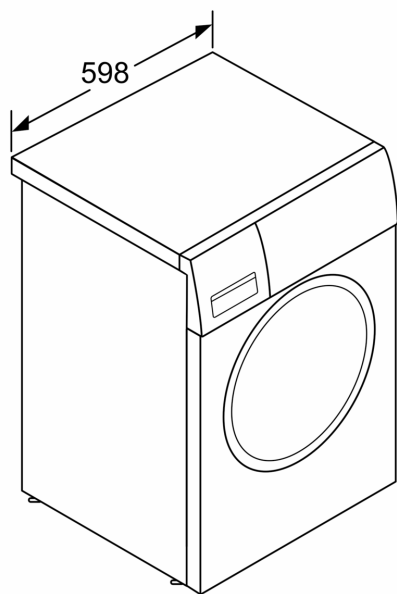

measurements in mm

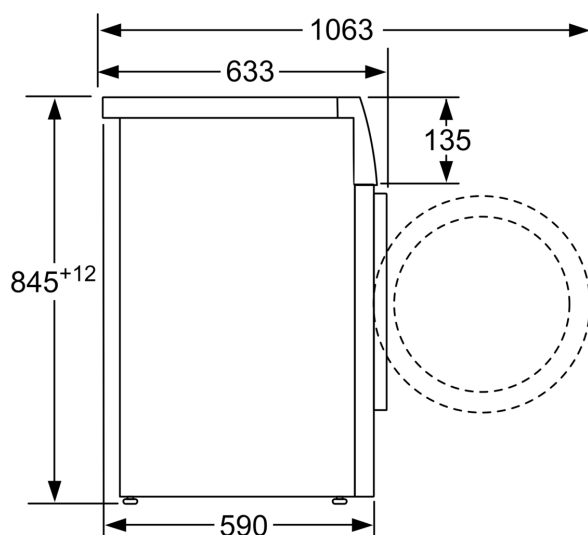

measurements in mm