

N 90, BUILT-IN OVEN WITH STEAM FUNCTION, 60
X 60 CM, GRAPHITE-GREY
B64FT53G0B



A⁺

2 x grid, 1 x universal pan, 1 x steam container, size XL, punched, 1
x Steam container, unpunched, size M

Z11AB15A0 Baking tray, non-stick ceramic coated, Z11AU15A0
Universal pan, non-stick ceramic coated, Z11CG10X1 AirFry & Grill
Set, Z11CR10X0 Baking and roasting grid (standard), Z11GU20X0
Glasspan, Z11SZ00X0 SeamlessCombination mounting kit,
Z11SZ80G0 SeamlessCombination 60 + 29cm, Z12CN10A0
Professional pan, enamelled, Z12CP10A0 Pizza pan, enamelled,
Z12CU10A0 Multipurpose pan, enamelled, Z1365WX0 Wireless
food thermometer, Z13CR10X0 Baking and roasting grid (steam),
Z13CV06S0 Decor strip, Z1608DX0 Full ext rails, level
independent, steam, Z1650BE0 Half tray, Z1650DU0 2
steamcontainer(punched/unpunched)sizeM, Z1655CA0 Air Fry &
Grill tray, Z11SZ90G0 SeamlessCombination 60 + 45cm,
Z12CB10A0 Baking tray, enamelled, Z12CL10A0 Lid for
professional pan, enamelled, Z12CM10A0 Moussaka pan,
enamelled

Built-in oven Intensive Steam with Slide & Hide® - the easy to
handle door that gently disappears under the oven and closes
smoothly. Multipoint Meatprobe with forecast function. Home
Connect - control your oven via the App.

- ✓ Premium 6.8-inch Full Touch TFT Display: easy and intuitive
interface for maximum comfort.
- ✓ Slide & Hide®: the easy-to-handle oven door that slides away for
unrestricted access.
- ✓ Intensive Steam: healthy steaming keeps your favourite dishes
full of flavour and nutrients.
- ✓ Steam Boost: quickly fills your oven with steam for ultimate
flavour and texture.
- ✓ Circo Therm®: the smart solution for simultaneous baking and
roasting on up to four levels.

Built-in / Free-standing: Built-in
Door opening: Drop down
Min. required niche size for installation (HxWxD): 585-595 x
560-568 x 550 mm
Dimensions: 595x596x548 mm
Dimensions of the packed product (HxWxD): . 675 x 660 x 690 mm
Control Panel Material: Stainless steel
Door Material: Glass
Net weight: 41.4 kg
Length electrical supply cord: 120.0 cm
EAN code: 4242004266174
Fuse protection: 16 A
Voltage: 220-240 V
Frequency: 50; 60 Hz
Plug type: no plug
(electrical connection by electrician)
Number of cavities (2010/30/EC): 1
Usable volume (of cavity) - NEW (2010/30/EC): 71 l
Energy efficiency rating: A+
Energy consumption per cycle conventional (2010/30/EC): 0.87
kWh/cycle
Energy consumption per cycle forced air convection
(2010/30/EC): 0.69 kWh/cycle
Energy efficiency index (2010/30/EC): 81.2 %
Included accessories: 2 x grid, 1 x universal pan, 1 x steam
container, punched, size XL, 1 x Steam container, punched, size M,
1 x Steam container, unpunched, size M



N 90, BUILT-IN OVEN WITH STEAM FUNCTION, 60
X 60 CM, GRAPHITE-GREY
B64FT53G0B

- Combi-steam oven with 22 heating methods: Top/bottom heat, Full surface grill, Centre surface grill, Bread baking, Bottom heat, Low temperature cooking, Plate warming, Keep warm, Conventional heat gentle, Steaming, Reheat with steam, Dough proving, Defrost, Circo-roasting, Bread Baking Setting, warming, 4D Hot air, Top/bottom heat

Design

- Graphite-Grey Edition
- Touch control
- Cavity inner surface: enamel anthracite

Features

- HomeConnect ready on WLAN
- Oven Assistant with Voice Control
- Control panel lock
- Automatic safety switch off Residual heat indicator Start button Door contact switch
- Full glass inner door

Programmes/functions

- Temperature range 40 °C - 250 °C
- LED light, On/off button
- Electronic clock timer
- Slide&Hide® with rotating handle
- Water tank empty indicator
- Location of water tank: Outside cavity
- SoftClose, SoftOpen
- Heat reflective glass
- Triple glazed door glazed CoolTouch door
- Temperature proposal
- Actual temperature display Heating up indicator Temperature probe
- cookControl Plus
- Rapid heat
- steam boost - add for 3min intensive steam with a touch of a button.
- There are different steam intensities selectable: steam level high, steam level middle, steam level low
- Cooling fan
- Stainless-steel fan

Level independent telescopic rails

- 4 shelf positions
- Available as an accessory

Cleaning

- EcoClean Direct: coating of ceiling, back panel, side liners
- EcoClean programme, Base Clean programme

Accessories

- 1 x steam container, punched, size XL, 1 x Steam container, unpunched, size M, 2 x grid, 1 x universal pan, 1 x Steam container, punched, size M

Performance/technical information

- 120 cm Cable length
- Nominal voltage: 220 - 240 V
- Total connected load electric: 3.6 KW
- Energy efficiency rating (acc. EU Nr. 65/2014): A+
- Energy consumption per cycle in conventional mode: 0.87 kWh
- Energy consumption per cycle in fan-forced convection mode: 0.69 kWh
- Number of cavities: Main cavity Heat source: electrical Cavity volume: 71 litre
- Appliance dimension (h x w x d): 595 mm x 596 mm x 548 mm
- Niche dimension (h x w x d): 585 mm - 595 mm x 560 mm - 568 mm x 550 mm
- Please refer to the dimensions provided in the installation manual

N 90, BUILT-IN OVEN WITH STEAM FUNCTION, 60
X 60 CM, GRAPHITE-GREY
B64FT53G0B

Installing two appliances on top of each other
Air exchange

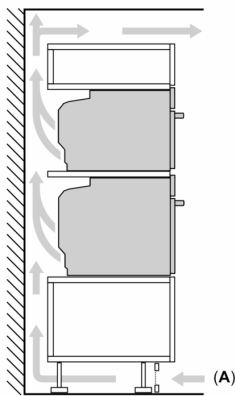

A: Air inlet $\geq 200 \text{ cm}^2$

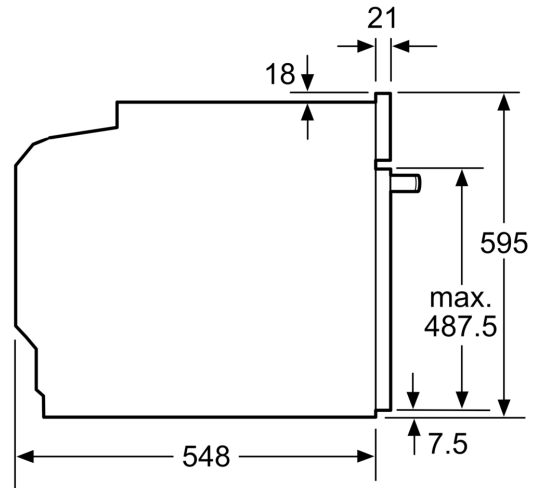

measurements in mm

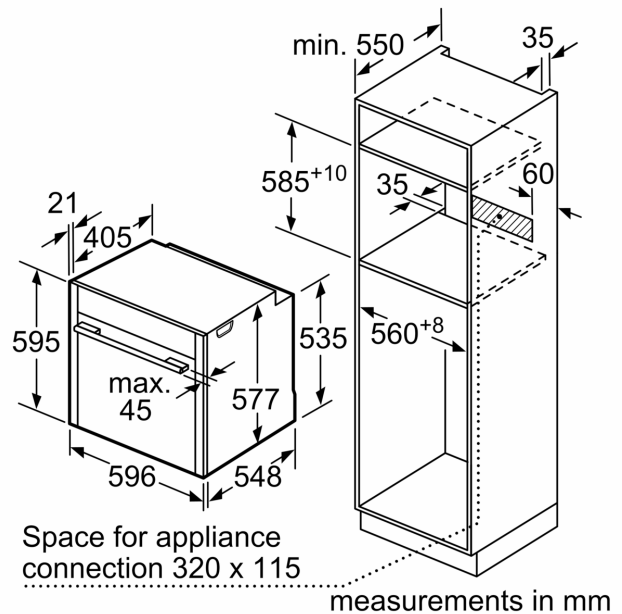
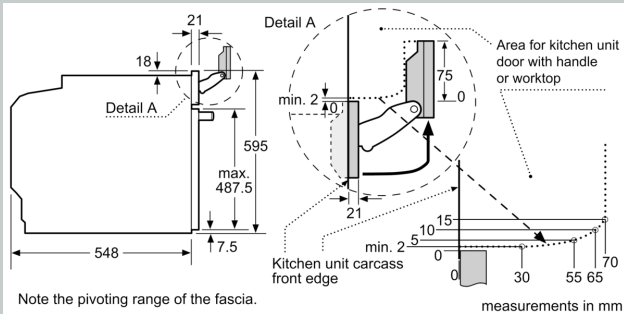

Space for appliance
connection 320 x 115

measurements in mm

